

Eumach

VERTICAL MACHINING CENTERS

新衛立式綜合加工機



VMC-1200/1400

CE

EMC / CE / ISO 9002 CERTIFIED

A PROFESSIONAL CNC MACHINES MANUFACTURER

VMC-1200/1400

THE Eumach MEDIUM SIZED,
UP TO 700 C.C./MIN ON STEEL

新衛中型立式綜合加工機#50主軸重切



- 鑄件全部經過應力消除，與時效處理，確保機台能長期保持要求之高精度及使用壽命。
- All castings are stress relieved and seasoning treated for long term accuracy and long service life.

- 三軸採方型滑軌支撐，大幅提昇穩定性與抗震性，滑軌經硬化熱處理、研磨，滑動界面貼附TURCITE-B，配合精細刮花技術，降低滑動磨擦提昇進給性能。Y軸軌道採4硬軌設計，跨距超大，工作台左右運動無懸空情形。
- 3-Axis by using box type sideway achieve heavy machining ability and overall, a structure of outstanding stability. All slideways are hardened, precision ground and coated with TURCITE-B and sophisticate hand-scraping allowing a low friction and steady movement Y-axis with 4 guideway box type sideway, X axis traveres with full support.

#50 TAPER SPINDLE MACHINES, HEAVY CUTTING S45C. (WITH SOME OPTIONS)

削中碳鋼S45C最高可達700cc/分鐘去除率。(需搭配選購配件)



- VMC1200: 1200mm X 700mm X 760mm
- VMC1400: 1400mm X 700mm X 760mm

SPINDLE (主軸)

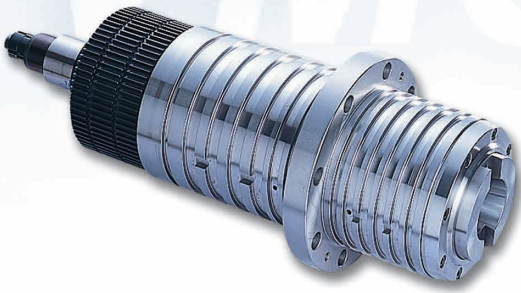

- Standard BT#50 6000RPM (optional up to 10000RPM) Cartridge type spindle incorporated P4 high precision angular contact bearings ensures the maximum rigidity and highest accuracy. Optional BT#40 8000RPM up to 12000RPM belt drive available.
- 標準BT # 50 6000 轉主軸 (或選配 10000轉) 砲彈式主軸方便維修，採用精密P4級主軸斜角滾珠軸承，確保主軸最大剛性及精度。另有選配 BT#40 8000轉至12000轉皮帶傳動式主軸。

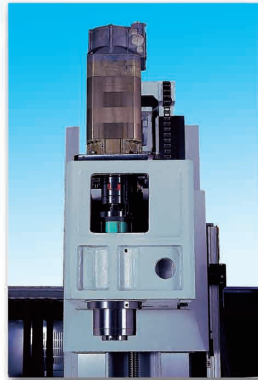

- Optional #40 taper direct coupling spindle, ceramic bearings inside, 12000RPM or 15000RPM.
- 選配 # 40直結式主軸，採用陶瓷軸承，速度可達 12000轉或15000轉。

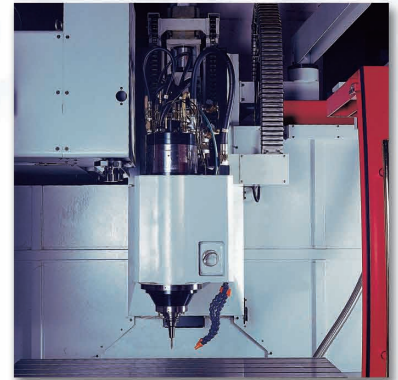

- Optional #40 or HSK-A63 taper built-in motor spindle. ceramic bearings inside spindle speed 18000RPM up to 24000RPM.
- 選配 # 40或 HSK-A63 內藏式主軸，採用陶瓷軸承，速度可達18000轉或 24000轉。

Carousel type magazine (standard) 斗笠式刀庫 (標準配備)

- The machine is equipped with a 20-tool BT#50 carousel-type magazine which features fast tool change in only 10 seconds.
- 本機標準配備20支BT#50斗笠式刀庫，快速換刀時間為10秒。



standard #50 taper:

Specification- 規格刀數 Capacity : 20
最大刀重 Max. tool weight : 12kg

optional #40 taper:

Specification- 規格刀數 Capacity : 20
最大刀重 Max. tool weight : 6kg

BALL SCREWS' 2 ENDS 滾珠螺桿兩端 :

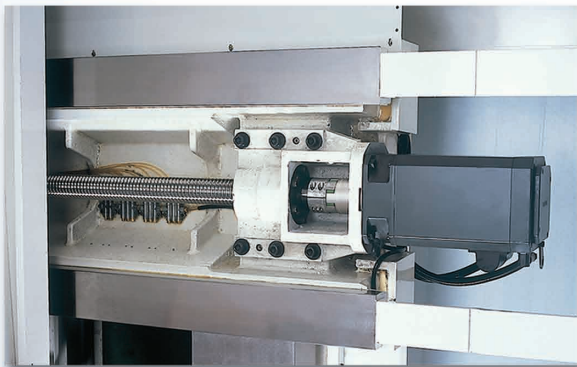

- 三軸螺桿與伺服馬達於兩側滑軌中央經由聯軸器直接連接。
- Large diameter ultra precision ballscrews directly coupled to the feed motor and are arranged in center of each guideways and close the cutting point.

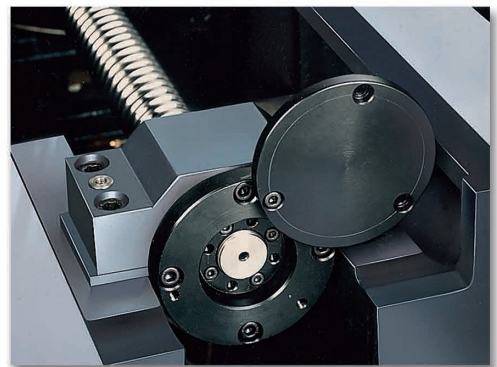

- Each ballscrew end support is with pre extensioned devices for absolute screw straightness and long life. (patent no.72650)

OPTIONAL ACCESSORIES (選購配件)



● TOOL LENGTH & RADIUS MEASUREMENT
刀長/徑量測



● RING TYPE COOLANT NOZZLES &
TOOL LENGTH MEASUREMENT
主軸環狀冷卻噴水及刀長量測



● ARM TYPE AUTOMATIC TOOL CHANGE
20 / 24 / 32 / 40 TOOLS
刀臂式自動換刀



● WORKPIECE PROBE
工件量測

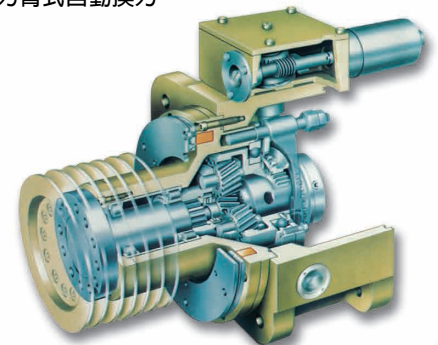

● PLANETARY GEARBOX HEAD
行星式齒輪箱主軸頭

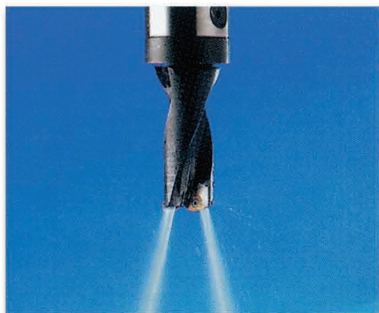

● COOLANT THRU SPINDLE DEVICE
主軸中心出水

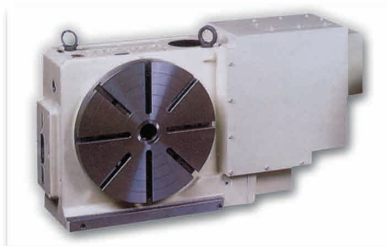

● CNC ROTARY TABLE
第4軸旋轉工作台



● CHAIN TYPE CHIP CONVEYOR
履帶式排屑機



● AXIS LINEAR GLASS SCALES
光學尺回饋

CNC CONTROLS AVAILABLE (控制器可選擇)



MITSUBISHI 三菱



FANUC 發那科
Oi-MC / 18i-MB



SIEMENS 西門子
840D/810D



HEIDENHAIN 海德漢
TNC-i530

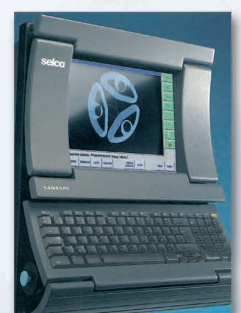

SELCA
S4045D/S4045PD

SPECIFICATIONS (規格)

UNIT:MM

MODEL	UNIT	VMC-1200	VMC-1400	
TABLE: 工作台:				
OVERALL SIZE	工作台尺寸	MM	1400×710	1500×710
WORKING AREA	工作範圍	MM	1400×710	1500×710
T SLOTS (SIZE×NO×PITCH)	T型槽 (尺寸×個數)	MM	18×6×125	18×6×125
MAXIMUMLOADING	荷重	KG	1500	1500
TRAVEL: 行程:				
X / Y / Z AXIS	X / Y / Z 軸	MM	1200/700/760	1400/700/760
DISTANCES: 距離:				
SPINDLE TO COLUMN WAYS	主軸中心到立柱軌道面	MM	760	760
SPINDLE TO TABLE TOP	主軸鼻端到工作台面	MM	125-885	125-885
FLOOR TO TABLE TOP	工作台面到地面	MM	850	850
SPINDLE: 主軸:				
TAPER	錐度	BT#	50	50
SPEED	轉速	RPM	6000	6000
FRONT BEARING DIAMETER	直徑	MM	90	90
MOTOR (日系)	馬達馬力 (30分定格)	KW	15	15
AXIS MOTORS : X & Y / Z 三軸馬達:				
HEIDENHAIN / SIEMENS / SELCA	海德漢/西門子	NM	20	20
CUTTING FEEDRATE	切削進給率	MM/MIN	1-8000	1-8000
RAPID FEEDRATE X / Y / Z :	三軸快率	M/MIN	15/15/12	15/15/12
MINMUM SETTING	最小設定單位	MM	0.001	0.001
AUTOMATIC TOOL CHNGER: 自動換刀機構:				
TYPE OF ATC	形式		CARROUSEL 日內瓦輪式	
NO. OF ATC	刀庫容量	TOOLS	20	20
MAX. TOOL (DIA / LENGTH)	最大刀徑/刀長	MM	125/300	125/300
MAX. TOOL WEIGHT	最大刀重	KG	15	15
TOOL TO TOOL	刀對刀	SEC.	10	10
CHIP TO CHIP	換刀動作完成	SEC.	20	20
BALLSCREWS ON 3 AXIS: 三軸滾珠螺桿:				
DIA. × PITCH (X.Y AXIS)	直徑×截徑	MM×MM	45×10	45×10
DIA. × PITCH (Z AXIS)	研磨精度	MM×MM	50×10	50×10
PRECISION CLASS	等級	C3, MM/300MM	0.008	0.008
COOLANT & LUBRICATION: 冷卻及自動潤滑機構:				
COOLANT MOTOR POWER	冷卻液馬達馬力	KW	0.86	0.86
COOLANT TANK VOLUME	冷卻水箱容量	L	120	120
COOLANT MOTOR CAPACITY	冷卻泵浦流量	L/MIN	20	20
LUBRICATION MOTOR POWER	自動注油器馬力	WATT	15	15
LUBRICATION TANK VOUME	自動注油氣油箱容量	L	2	2
ACCURACY: 精度:				
POSITIONING	定位精度	MM	JIS 6338:±0.005MM / 300MM	VDI 3441:P0.014MM
REPEATABILITY	重複精度	MM	JIS 6338:±0.003MM	VDI 3441:PS0.01MM
ROUNDNESS	循圓精度	MM	JIS 6338:±0.01MM / 300MM	DIAMETER
MISCELLANEOUS: 其他:				
MACHINE NET WEIGHT	機械淨重	KG	12000	13000
POWER REQUIRED	電力需求	KVA	25	25
PNEUMATIC REQUIRED	空壓機壓力	KG/CM ²	7	7

STANDARD FEATURES & ACCESSORIES 標準附件

- FULL SPLASH GUARD.
- AUTOMATIC LUBRICATION SYSTEM.
- SPINDLE AIR BLAST SYSTEM.
- SPINDLE OIL COOLER DEVICE.
- WORKING LAMP.
- LEVELLING BOLTS & PADS.
- INDICATION LAMP FOR DWELL & END OF JOB.
- ALARM LAMP FOR ABNORMAL SITUATION.
- RS-232 TERMINAL INTERFACE PORT.
- MACHINE & CONTROL MANUALS.
- TOOLBOX WITH SPANNERS & WRENCHES.
- PROGRAMMABLE COOLANT SYSTEM.
- 全密式防屑罩
- 自動潤滑裝置
- 主軸吹氣裝置
- 主軸油冷機
- 工作照明燈
- 水平調整螺絲與基礎塊
- 暫停與工作完成指示燈
- 機械異常狀況警示燈
- RS-232介面
- 機械控制器手冊
- 工具箱附調整工具
- 可程式切削冷卻裝置

PULL STUD, TOOL SHANK (拉拴及刀柄)

PULL-STUD

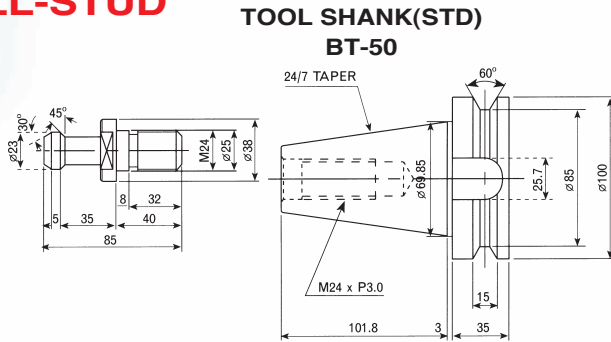

TOOL SHANK(OPT) CAT-50/DIN69871

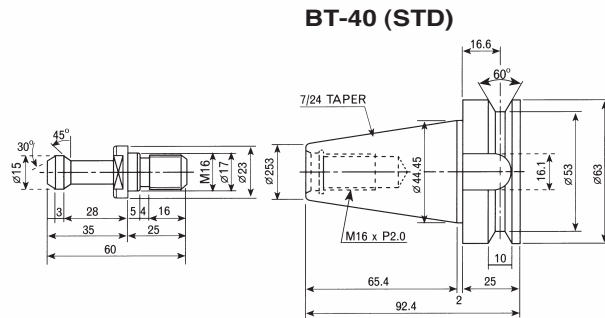
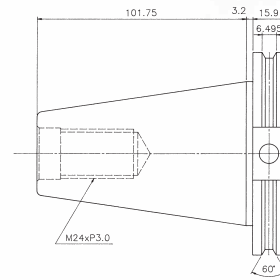

CAT-40/DIN69871 (STD)

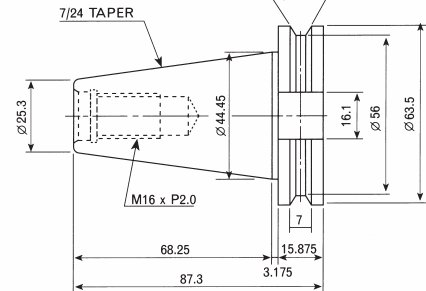

MACHINES DIMENSIONS (機器佔地尺寸)

VMC-1200/1400

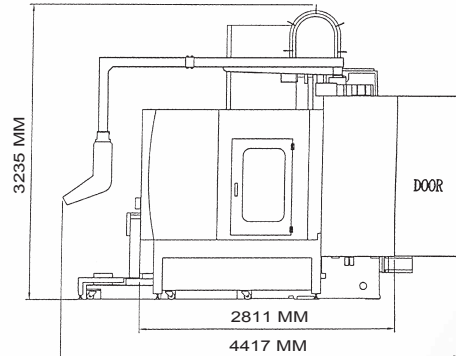
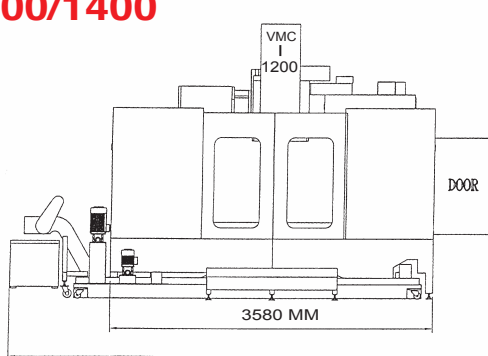

THE MACHINE QUALITY QUARANTEEE (品質保證)



● LASER INSPECTED 雷射檢驗

Positioning 定位精度 MM

Repeatability 重複精度 MM

Roundness 切圓精度 MM

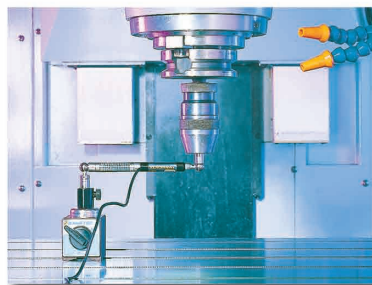

● BALLBAR TEST 循圓測試

JIS 6388 : ±0.005mm / 300mm
VDI 3441:P0.014mm

JIS 6388 : ±0.003mm
VDI 3441:PS0.014mm

JIS 6388 : ±0.01mm / 300mm
DIAMETER



● SPINDLE VIBRATION TEST 主軸震動測試

ANY RPM SHOULD BE UNDER 3 μm
任何轉速都在3 μm以下。

WORLDWIDE SALES 外銷國家



OTHER PRODUCTS 其他系列產品

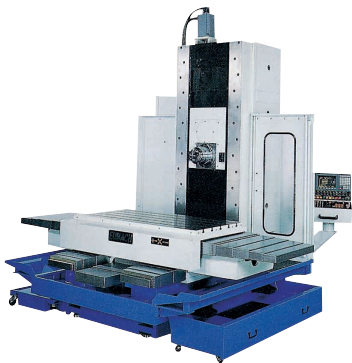

EBM SERIES HORIZONTAL MILL.
X AXIS UP TO 3200MM.
EBM系列臥式銑床

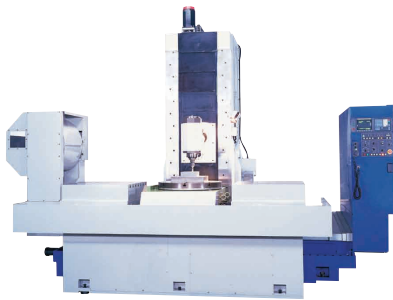

MB SERIES HORIZONTAL MILL.
3 AXIS TRAVELLING COLUMN
MACHINE, X AXIS UP TO 3200MM.
MB系列三軸動力柱式銑床



UMC-1000 HIGH SPEED UNIVERSAL
MILLING CENTER.
萬能銑削中心機



VMC SERIES C FRAMS VMC.
X AXIS UP TO 3200MM.
VMC系列立式綜合加工機



DVM SERIES BRIDGE TYPE VMC.
X AXIS UP TO 6000MM.
DVM系列龍門立式綜合加工機



FBE SERIES BED TYPE MILLING MACHINES.
X AXIS UP TO 4000MM.
FBE系列萬能銑床

Eumach Co.,LTD.

新衛電腦機械股份有限公司

★ Specifications subject to change without notice.
規格更改，恕不另行通知。

Catalogue No.95030302

2, YING LIN LANE, HO SHENG ST., HO SHENG VILLAGE,
SHIH KANG HSIANG, TAICHUNG HSIEN, TAIWAN, 422, R.O.C.
台中縣石岡鄉和盛村和盛街營林巷2號
TEL:886-4-25810031 FAX:886-4-25810003
E-mail:eumach@ms8.hinet.net
http://www.eumach.com