

# COOLANT-PUMPS

## ALB-过滤系列离心泵

## ALB-Had.Filter serier

### 产品的特征 Product characteristics

ALB-HF型是一种上吸式浸入式泵，不需要注油。  
 由于没有密封装置，不会因空转引起故障。  
 且外观设计紧美观，结构独特，性能稳定。  
 广泛适用于不太要求扬程的机床设备。

ALBHF type is a type submerged pump, do not need oiling.  
 Since there is no sealing device, not because of idling fault.  
 And the design is beautiful, unique structure, stable performance.  
 Widely applicable to lift requirements of the machine tool equipment.

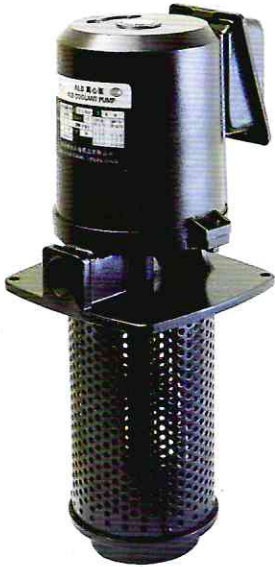

TYPE 型号	Discharge Volume 流量 L/min	Total head 扬程 m	Outlet 吐出口 Rc	Immersion Depth 浸水深度 L Mm	Noise 噪音	Motor Out-put 功率 Kw	Fre- quency 频率 Hz	Rated Voltage 电压 V	Current 电流 A
ALB-130HF-25/H	25	4	1/2	125	50	0.13	50	220/380	0.65/0.38
ALB-130HF-25/H			1/2	175		0.13			
ALB-130HF-25/H			1/2	215		0.13			
ALB-130HF-25/H			1/2	245		0.13			
ALB-180HF-50/H	50	5.5	3/4	129	50	0.18	50	220/380	0.91/0.52
ALB-180HF-50/H			3/4	179		0.18			
ALB-180HF-50/H			3/4	219		0.18			
ALB-180HF-50/H			3/4	250		0.18			
ALB-180HF-50/H			3/4	350		0.18		220/380	0.91/0.52

由于设计的改进等原因令某些数值的变更,恕不另行通知

其余浸水深度可根据用户需求生产;  
 电压、频率可根据用户需求生产。

The rest of the immersed depth can be based on user demand for the production of;

Voltage, frequency can be based on user demand for the production of.

适用液体粘度在32cSt以下 (below32cSt)

Application of the liquid viscosity on the following 32cSt ( below32cSt )

防护等级(Enclosure class):

Ip54: ALB-130HF~180HF

绝缘等级(Insulation class): F

# COOLANT-PUMPS

Immersible pumps  
50Hz

性能曲线 Performance curve

外形图 Appearance in figure

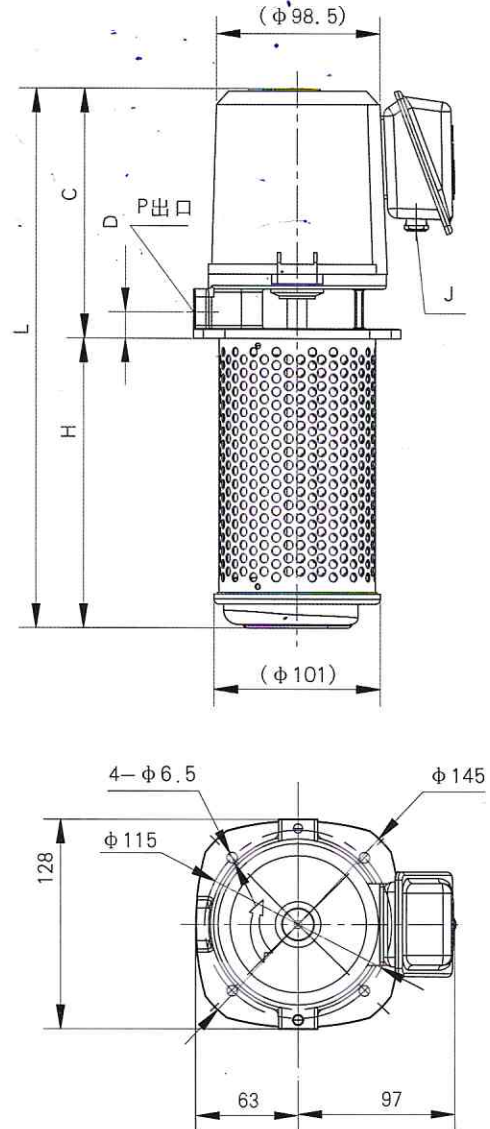
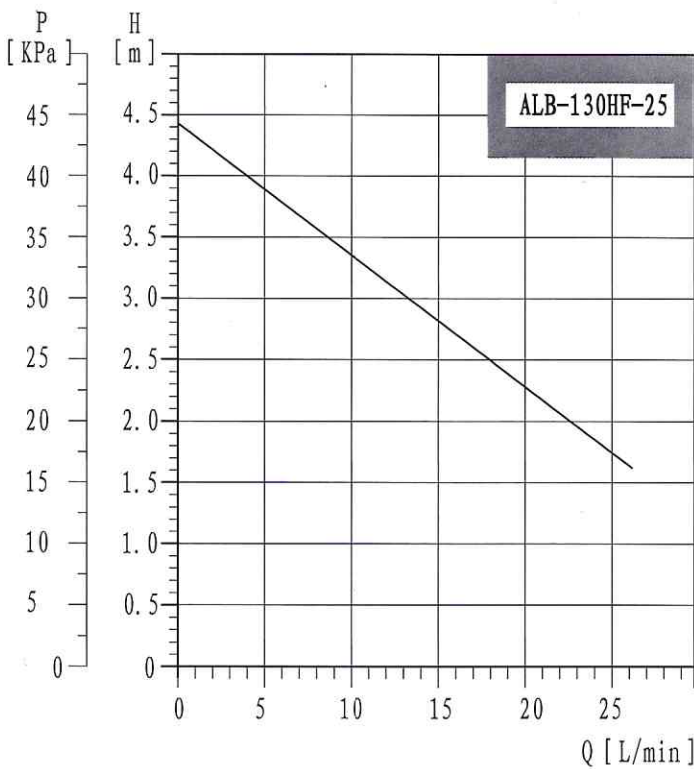

PUMP TYPE 泵的型号	安装尺寸 Mounting dimensions					
	L	H	C	D	P	J最大 出线口径 (φ)
ALB-130HF-25/H	276	125	151	17	Rc1/2	15
ALB-130HF-25/H	326	175	151	17	Rc1/2	15
ALB-130HF-25/H	366	215	151	17	Rc1/2	15
ALB-130HF-25/H	396	245	151	17	Rc1/2	15

适用 (Applications)  
使用液体 (Type of fluid)  
冷却水 Water/Coolant  
切削油 Cutting oils  
磨油 Grinding oils  
粘度 (Viscosity) 1~32cSt  
使用温度 (Temperature)  
80°以下

材质(Material)  
电机壳体(Motor frame): 合金铝  
泵体(Pump body): 铸铝  
套杆(Casing): 不锈钢  
叶轮(Impeller): 不锈钢  
机轴(Shaft): 钢

由于设计的改进等原因令某些数值的变更,恕不另行通知

# COOLANT-PUMPS

## ALB-过滤系列离心泵

ALB-Had.Filter series  
50Hz

性能曲线 Performance curve

外形图 Appearance in figure

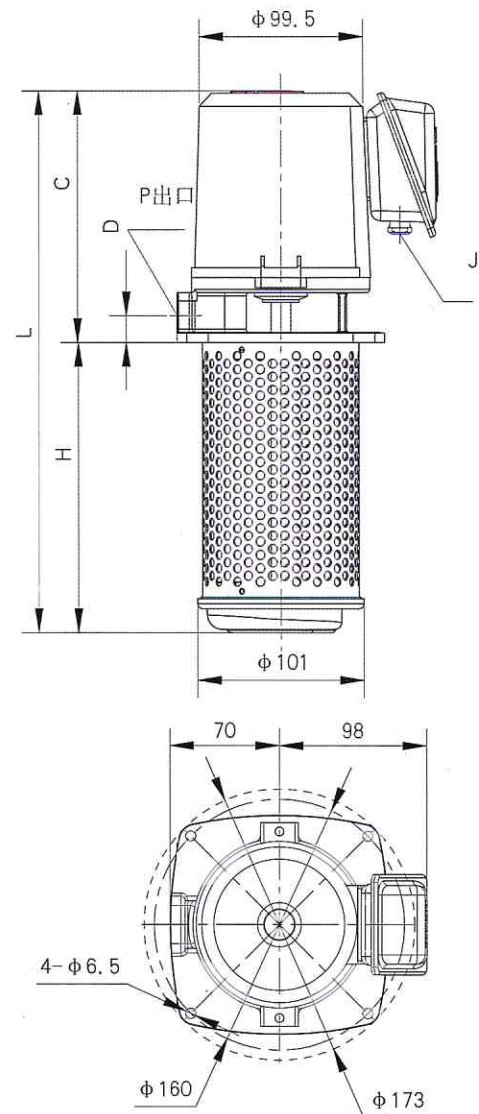
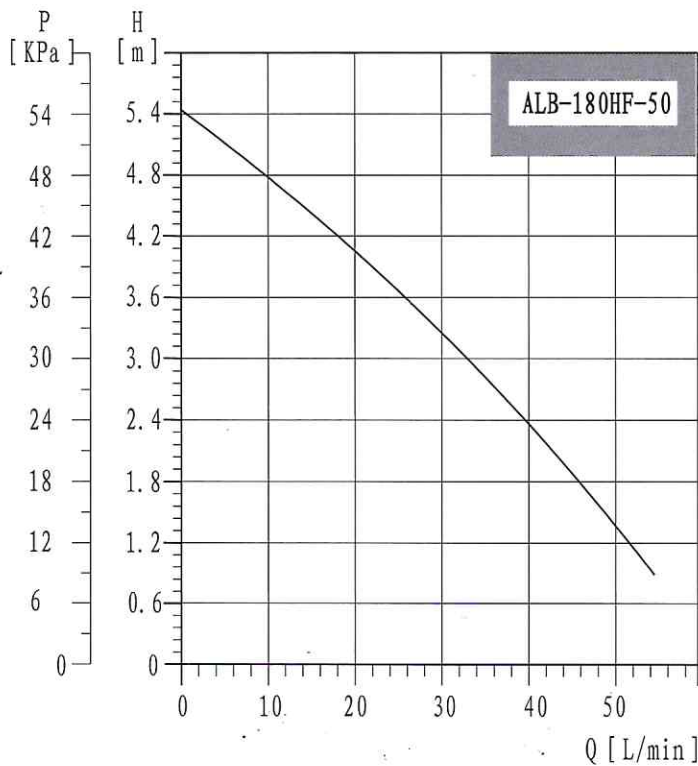

PUMP TYPE 泵的类型	安装尺寸 Mounting dimensions					
	L	H	C	D	P	J最大 出线口径 (φ)
ALB-180HF-50/H	296	129	167	22	Rc3/4	15
ALB-180HF-50/H	346	179	167	22	Rc3/4	15
ALB-180HF-50/H	386	219	167	22	Rc3/4	15
ALB-180HF-50/H	417	250	167	22	Rc3/4	15
ALB-180HF-50/H	517	350	167	22	Rc3/4	15

由于设计的改进等原因令某些数值的变更,恕不另行通知

适用 (Applications)  
使用液体 (Type of fluid)  
冷却水 Water/Coolant  
切削油 Cutting oils  
磨油 Grinding oils  
粘度 (Viscosity)1~  
32cSt  
使用温度  
(Temperature)  
80°以下

材质(Material)  
电机壳体(Motor  
frame):合金铝  
泵体(Pump body):铸铝  
套杆(Casing): 不锈钢  
叶轮(Impeller):不锈钢  
机轴(Shaft): 钢

# COOLANT-PUMPS

Immersible pumps  
50Hz

## 产品的特征 Product characteristics

ALB-HF是一种上吸式浸入式泵，不需要注油。适用于要求一定扬程流量的高精密、高性能设备。

主要用冷却加工物，提高表面光泽度，分散排屑及洗涤等。

由于没有密封装置，不会因空转而引起故障。且外观美观，结构独特，性能稳定。

ALBHF is a type submerged pump, do not need oiling. Applicable to the requirements of head flow of high precision, high equipment.

Primary cooling process, improve the surface gloss, dispersed chip, and washing.

Since there is no sealing device for idling, not caused by fault. And the appearance is beautiful, unique structure, stable performance.



TYPE 型号	Discharge Volume 流量 L/min	Total head 扬程 m	Outlet 吐出口 Rc	Immersion Depth 浸水深度 L Mm	Noise 噪音	Motor Out-put 功率 Kw	Fre- quency 频率 Hz	Rated Voltage 电压 V	Current 电流 A
ALB-180HF-80/H	80	8	3/4	150	50	0.18	50	220/380	0.91/0.52
ALB-180HF-80/H			3/4	180		0.18		220/380	0.91/0.52
ALB-180HF-80/H			3/4	235		0.18		220/380	0.91/0.52
ALB-180HF-80/H			3/4	285		0.18		220/380	0.91/0.52
ALB-370HF-100/H	100	8	1	190	50	0.37	50	220/380	1.67/0.96
ALB-370HF-100/H			1	239		0.37		220/380	1.67/0.96
ALB-370HF-100/H			1	290		0.37		220/380	1.67/0.96
ALB-370HF-100/H			1	340		0.37		220/380	1.67/0.96
ALB-550HF-150/H	150	12	1/4	190	50	0.55	50	220/380	2.33/1.35
ALB-550HF-150/H			1/4	239		0.55		220/380	2.33/1.35
ALB-550HF-150/H			1/4	290		0.55		220/380	2.33/1.35
ALB-550HF-150/H			1/4	340		0.55		220/380	2.33/1.35

由于设计的改进等原因令某些数值的变更,恕不另行通知

其余浸水深度可根据用户需求生产;

电压、频率可根据用户需求生产。

The rest of the immersed depth can be based on user demand for the production of;

Voltage, frequency can be based on user demand for the production of.

适用液体粘度在32cSt以下 (below 32cSt)

Application of the liquid viscosity on the following 32cSt (below 32cSt)

防护等级(Enclosure class): Ip55

绝缘等级(Insulation class): F

# COOLANT-PUMPS

Immersible pumps  
50Hz

性能曲线 Performance curve

外形图 Appearance in figure

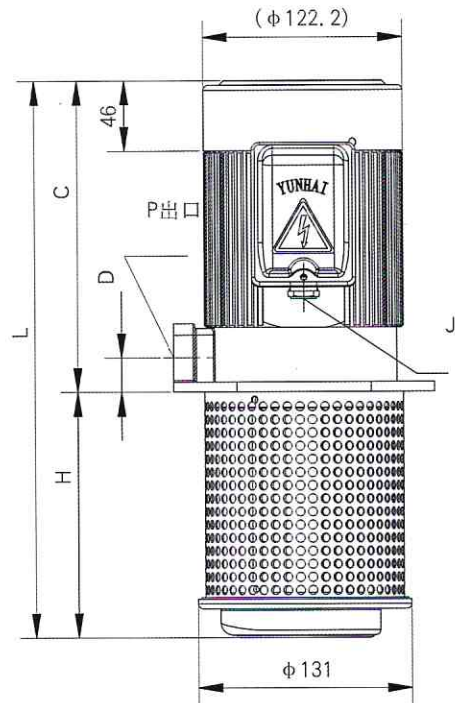
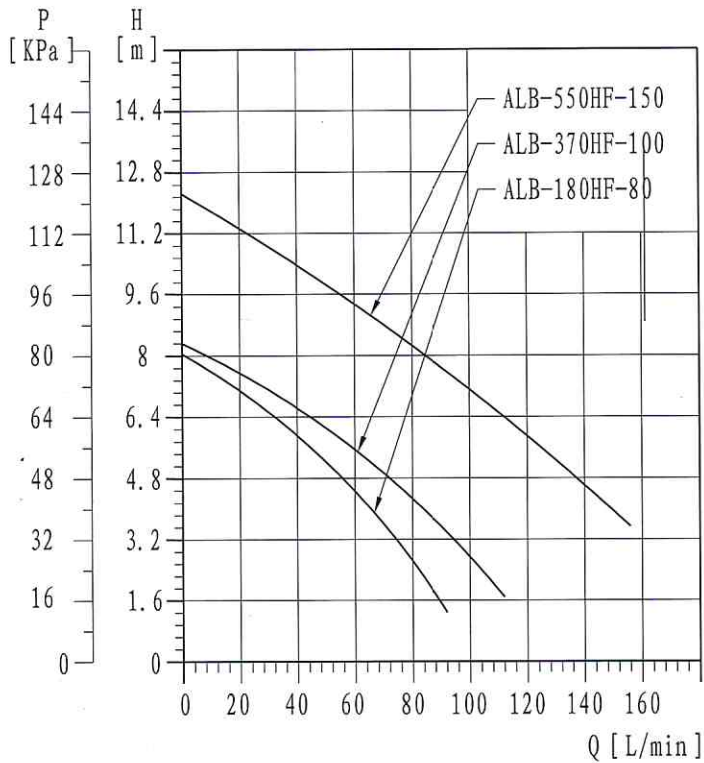

PUMP TYPE 泵的型号	安装尺寸 Mounting dimensions					
	L	H	C	D	P	J最大 出线口径 ( $\phi$ )
ALB-180HF-80/H	343	150	193	23	Rc3/4	15
ALB-180HF-80/H	373	180	193	23	Rc3/4	15
ALB-180HF-80/H	428	235	193	23	Rc3/4	15
ALB-180HF-80/H	478	285	193	23	Rc3/4	15
ALB-370HF-100/H	419	190	229	30	Rc1	15
ALB-370HF-100/H	468	239	229	30	Rc1	15
ALB-370HF-100/H	519	290	229	30	Rc1	15
ALB-370HF-100/H	569	340	229	30	Rc1	15
ALB-550HF-150/H	437	190	247	30	Rc1 1/4	15
ALB-550HF-150/H	486	239	247	30	Rc1 1/4	15
ALB-550HF-150/H	537	290	247	30	Rc1 1/4	15
ALB-550HF-150/H	587	340	247	30	Rc1 1/4	15

由于设计的改进等原因令某些数值的变更,恕不另行通知

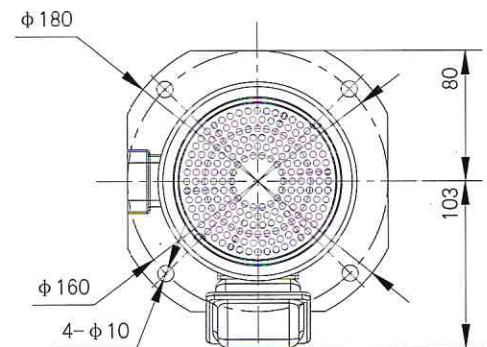

适用 (Applications)  
使用液体 (Type of fluid)  
冷却水 Water/Coolant  
切削油 Cutting oils  
磨油 Grinding oils  
粘度 (Viscosity) 1~  
32cSt  
使用温度 (Temperature)  
80°以下

材质 (Material)  
电机壳体 (Motor  
frame): 合金铝  
泵体 (Pump body): 铸铝  
套杆 (Casing): 不锈钢  
叶轮 (Impeller): 不锈钢  
机轴 (Shaft): 钢

# COOLANT-PUMPS

## ALB-过滤系列离心泵

## ALB-Had.Filter serier

### 产品的特征 Product characteristics

ALB-HF是一种上吸式浸入式泵，不需要注油。适用于要求流量扬程的高精密、高性能设备。主要用冷却加工物，提高表面光泽度，分散排屑及洗涤等。

由于没有密封装置，不会因空转而引起故障。且外观美观，结构独特，性能稳定。

ALBHF is a type submerged pump, do not need oiling. Applicable to the requirements of head flow of high precision, high equipment.

Primary cooling process, improve the surface gloss, dispersed chip and washing.

Since there is no sealing device for idling, not caused by fault. And the appearance is beautiful, unique structure, stable performance.



TYPE 型号	Discharge Volume 流量 L/min	Total head 扬程 m	Outlet 吐出口 Rc	Immersion Depth 浸水深度 L Mm	Noise 噪音	Motor Out-put 功率 Kw	Fre- quency 频率 Hz	Rated Voltage 电压 V	Current 电流 A
ALB-400HF-100/H	100	10	1	176	50	0.40	50	220/380	1.74/1.04
ALB-400HF-100/H			1	240		0.40		220/380	1.74/1.04
ALB-400HF-100/H			1	290		0.40		220/380	1.74/1.04
ALB-400HF-100/H			1	340		0.40		220/380	1.74/10.4
ALB-600HF-200/H	200	15	1¼	180	50	0.60	50	220/380	2.53/1.46
ALB-600HF-200/H			1¼	244		0.60		220/380	2.53/1.46
ALB-600HF-200/H			1¼	294		0.60		220/380	2.53/1.46
ALB-600HF-200/H			1¼	344		0.60		220/380	2.53/1.46
ALB-750HF-250/H	250	15	1¼	235	50	0.75	50	220/380	3.03/1.75
ALB-750HF-250/H			1¼	285		0.75		220/380	3.03/1.75
ALB-750HF-250/H			1¼	340		0.75		220/380	3.03/1.75
ALB-1.1kwHF-300/H	300	16	1½	240	50	1.10	50	220/380	4.41/2.55
ALB-1.1kwHF-300/H			1½	290		1.10		220/380	4.41/2.55
ALB-1.1kwHF-300/H			1½	345		1.10		220/380	4.41/2.55

由于设计的改进等原因令某些数值的变更,恕不另行通知

其余浸水深度可根据用户需求生产;

电压、频率可根据用户需求生产。

The rest of the immersed depth can be based on user demand for the production of;

Voltage, frequency can be based on user demand for the production of.

适用液体粘度在32cSt以下 (below32cSt)

Application of the liquid viscosity on the following 32cSt (below32cSt)

防护等级(Enclosure class): Ip55

绝缘等级(Insulation class): F

# COOLANT-PUMPS

Immersible pumps  
50Hz

性能曲线 Performance curve

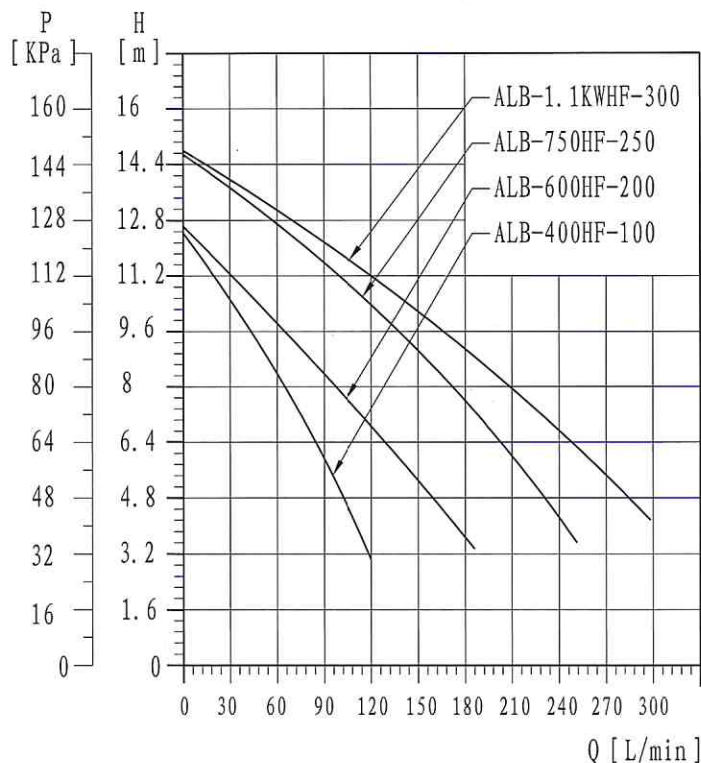

外形图 Appearance in figure

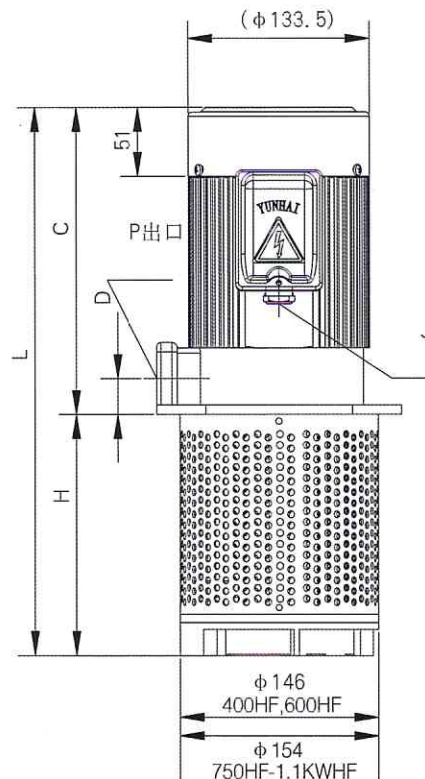

PUMP TYPE 泵的型号	安装尺寸 Mounting dimensions					
	L	H	C	D	P	J最大 出线口径 (φ)
ALB-400HF-100/H	401	176	225	28.5	Rc1	15
ALB-400HF-100/H	465	240	225	28.5	Rc1	15
ALB-400HF-100/H	515	290	225	28.5	Rc1	15
ALB-400HF-100/H	565	340	225	28.5	Rc1	15
ALB-600HF-200/H	441	180	261	33.5	Rc1¼	15
ALB-600HF-200/H	505	244	261	33.5	Rc1¼	15
ALB-600HF-200/H	555	294	261	33.5	Rc1¼	15
ALB-600HF-200/H	605	344	261	33.5	Rc1¼	15
ALB-750HF-250/H	513	235	278	37.5	Rc1¼	15
ALB-750HF-250/H	563	285	278	37.5	Rc1¼	15
ALB-750HF-250/H	618	340	278	37.5	Rc1¼	15
ALB-1.1kwHF-300/H	538	240	298	37.5	Rc1½	15
ALB-1.1kwHF-300/H	588	290	298	37.5	Rc1½	15
ALB-1.1kwHF-300/H	643	345	298	37.5	Rc1½	15

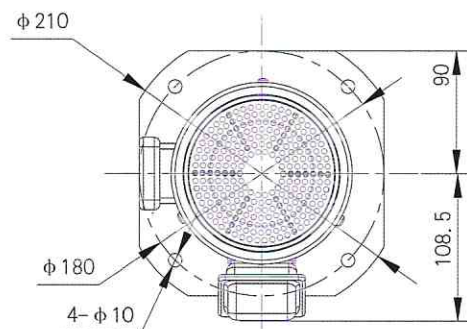

适用 (Applications)  
使用液体 (Type of fluid)  
冷却水 Water/Coolant  
切削油 Cutting oils  
磨油 Grinding oils  
粘度 (Viscosity) 1~32cSt  
使用温度 (Temperature)  
80°以下

材质 (Material)  
电机壳体 (Motor frame): 合金铝  
泵体 (Pump body): 铸铝  
套杆 (Casing): 不锈钢  
叶轮 (Impeller): 不锈钢  
机轴 (Shaft): 钢

由于设计的改进等原因令某些数值的变更,恕不另行通知

# COOLANT-PUMPS

## ALBT-过滤系列离心泵

ALBT-Had.Filter series

### 使用时注意事项 Operating Cautions

容器的液面要维持在泵体上下限刻度范围内。最高液面维持在法兰盘下方20mm处最为适当(参图1)如果液面超出了上限,会从法兰盘的缝隙飞溅,如果液面达不到下限,会有空气混入,产生噪音,导致泵的性能降低。

Container liquid level must be maintained at the pump body Lower limit of scale range. The highest level is maintained in the flange below 20mm most appropriate (see Figure 1) if the liquid level exceeds the limit, from the flange of the slit splash, if the level is not up to the lower limit, there will be air into, noise,

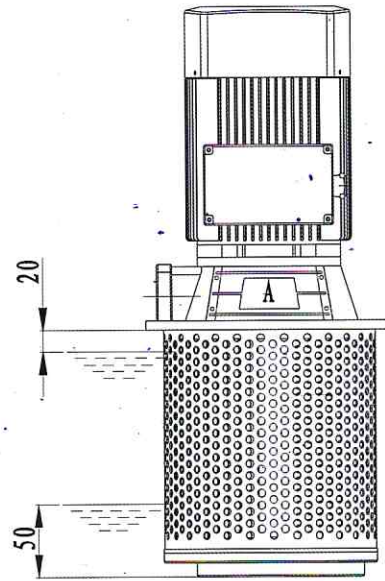

(图1 Refer drawing #1)

### Suctional drawing 部件图

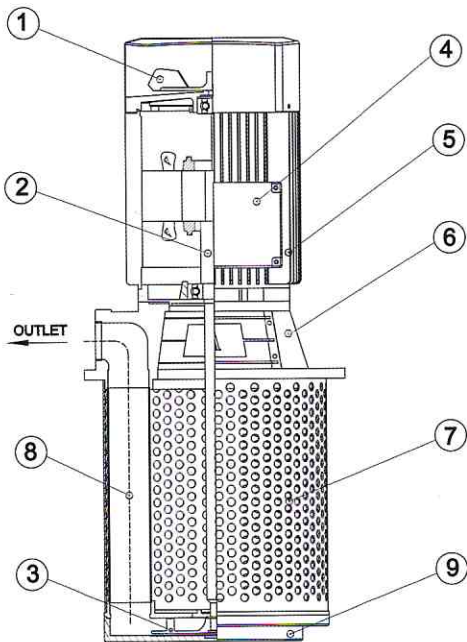

NO.1	Name	名称
1	Fan	风叶
2	Shaft	机轴
3	Impeller	叶轮
4	Terminal box	接线盒
5	Motor	电机
6	Water outlet seat	出水座
7	Filter	滤网
8	Casing	套管
9	Pump body	泵体

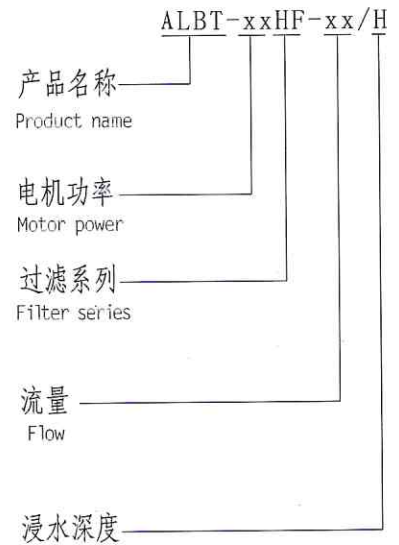



# COOLANT-PUMPS

## ALBT-过滤系列离心泵

ALBT-Had.Filter serier

### 产品的特征 Product characteristics

ALBT-HF除具有ALB-HF特点外，更适用于大流量高扬程的机床设备。

介质可以有一定黏度、颗粒、粉末、的杂质混合的液体。

特别适用于光伏产业机床设备。

叶轮材质是不锈钢，所以具有耐腐蚀性良好，效率高。

又由于没有密封装置，不会因空转引起泵的故障。

ALBT-HF has ALBHF features, is more suitable for large flow and high lift machine tool equipment.

Media can have some viscosity, particle, powder, impurity mixed liquid.

Particularly applicable to the photovoltaic industry machine tool equipment.

The impeller is made from stainless steel, so it has good corrosion resistance, high efficiency.

Because no sealing device for idling, not caused by pump failure.



PUMP TYPE 泵的型号	安装尺寸 Mounting dimensions								
	Discharge Volume 流量 L/min	Total head 扬程 m	Outlet 吐出口 Rc	Immersion Depth 浸水深度 L Mm	Noise 噪音	Motor Out-put 功率 Kw	Fre-quency 频率 Hz	Rated Voltage 电压 V	Current 电流 A
ALBT-4kwHF-600/H	600	30	2	320	60	4.0	50	380	8.12
ALBT-5.5kwHF-800/H	800	36	2	320	60	5.5	50	380	11.04

由于设计的改进等原因令某些数值的变更,恕不另行通知

其余浸水深度可根据用户需求生产;

电压、频率可根据用户需求生产。

The rest of the immersed depth can be based on user demand for the production of;

Voltage, frequency can be based on user demand for the production of.

适用液体粘度在32cSt以下 (below 32cSt)

Application of the liquid viscosity on the following 32cSt (below 32cSt)

防护等级(Enclosure class): Ip55

绝缘等级(Insulation class): F

# COOLANT-PUMPS

Immersible pumps  
50Hz

性能曲线 Performance curve

外形图 Appearance in figure

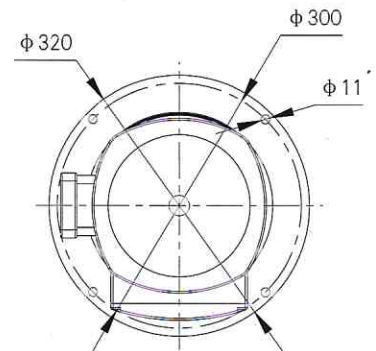
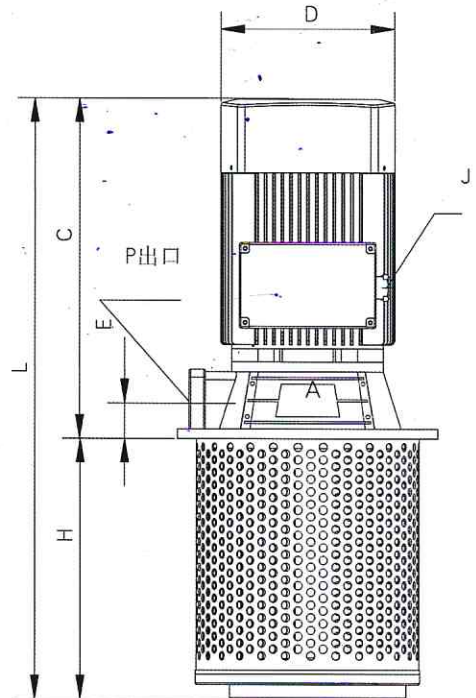
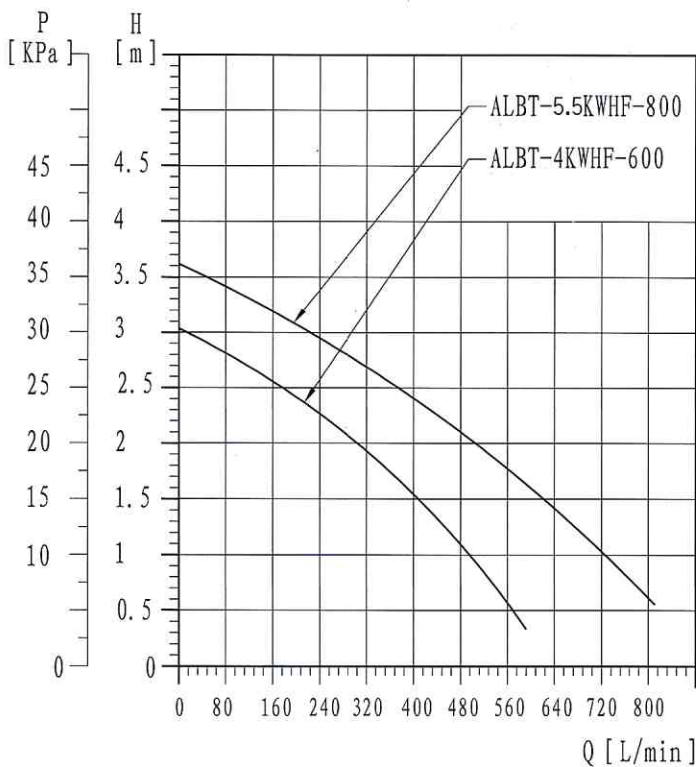

PUMP TYPE 泵的型号	安装尺寸 Mounting dimensions						
	L	H	C	D	E	P	J 最大出线口 径( $\phi$ )
ALBT-4kwHF-600/H	719	320	399	215	47	Rc2	15
ALBT-5.5kwHF-800/H	793	320	473	255	47	Rc2	15

由于设计的改进等原因令某些数值的变更,恕不另行通知

适用 (Applications)  
使用液体 (Type of fluid)  
冷却水 Water/Coolant  
切削油 Cutting oils  
磨油 Grinding oils  
粘度 (Viscosity) 1~32cSt  
使用温度 (Temperature)  
80°以下

材质(Material)  
电机壳体(Motor  
frame):合金铝  
泵体(Pump body):铸铝  
套杆(Casing): 不锈钢  
叶轮(Impeller): 不锈钢  
机轴(Shaft): 钢